

HM 52 T

Dimensions

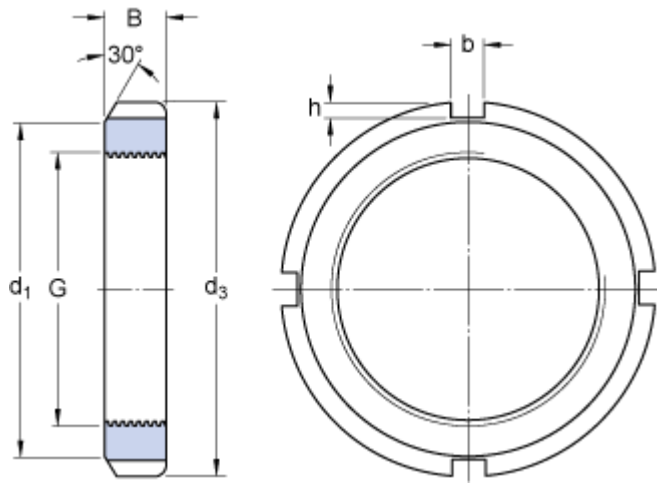

G	Tr 260x4	
d ₃	330	mm
B	36	mm
d ₁	300	mm
b	24	mm
h	12	mm

Mass

Mass lock nut	7.55	kg
---------------	------	----

Mounting information

Appropriate spanner	TMFN 52-64
---------------------	------------

Appropriate products

Lock washer	MB 52
-------------	-------